

Atlante
Design



WE FACILITATE AND GET THINGS DONE!
So that artisan&designers can focus on being creative.

ATLANTE Design is an international B2B commercial consultancy specializing in handmade, authorial design.

We represent a curated portfolio of artisans & designers who prioritize quality over quantity and embrace sustainable practices in sourcing and production. Through these partnerships, we offer a diverse and high-quality selection of materials and products tailored to discerning buyers and brands seeking authenticity, craftsmanship, and responsible innovation.

Everything is made to order, customizable and artisanal.

We specialise in creating a link between the designers and their products with the right retailers and galleries, the buyers and the specifier.

We focus on building trusted creative partnerships, curating collaborations, supporting emergent designers and S.M.E.s, introducing designers and makers to new audiences, maintaining continuity and reputation.

Designers

ARTISANAL SURFACE

- De Marchi Verona
- Ninfifty

FURNITURE

- Dante Negro
- La Manufacture
- Cider
- Mediterranea

INDEPENDENT DESIGNERS-MAKERS:

Unique Pieces, Accessories & Lifestyle

- Ari De Luca
- CContinua + MAMT
- Giovanni Botticelli
- Giorgio Bena
- Stamuli

SPECIAL COLLAB

- BXCSY for Sidreh

ARTISANAL SURFACE

De Marchi Verona

Handmade Porcelain Tiles

When innovation meets passion and tradition.

The richness of porcelain translates into three-dimensional surfaces with an extraordinary variety of colors and textures, evoking inspirations ranging from classic art and pre-Columbian mythology to art deco and 1950s punk fashion references.

Looking to the future, the commitment remains to exploring new frontiers, collaborating with visionary designers, and introducing groundbreaking porcelain solutions for architecture and design.

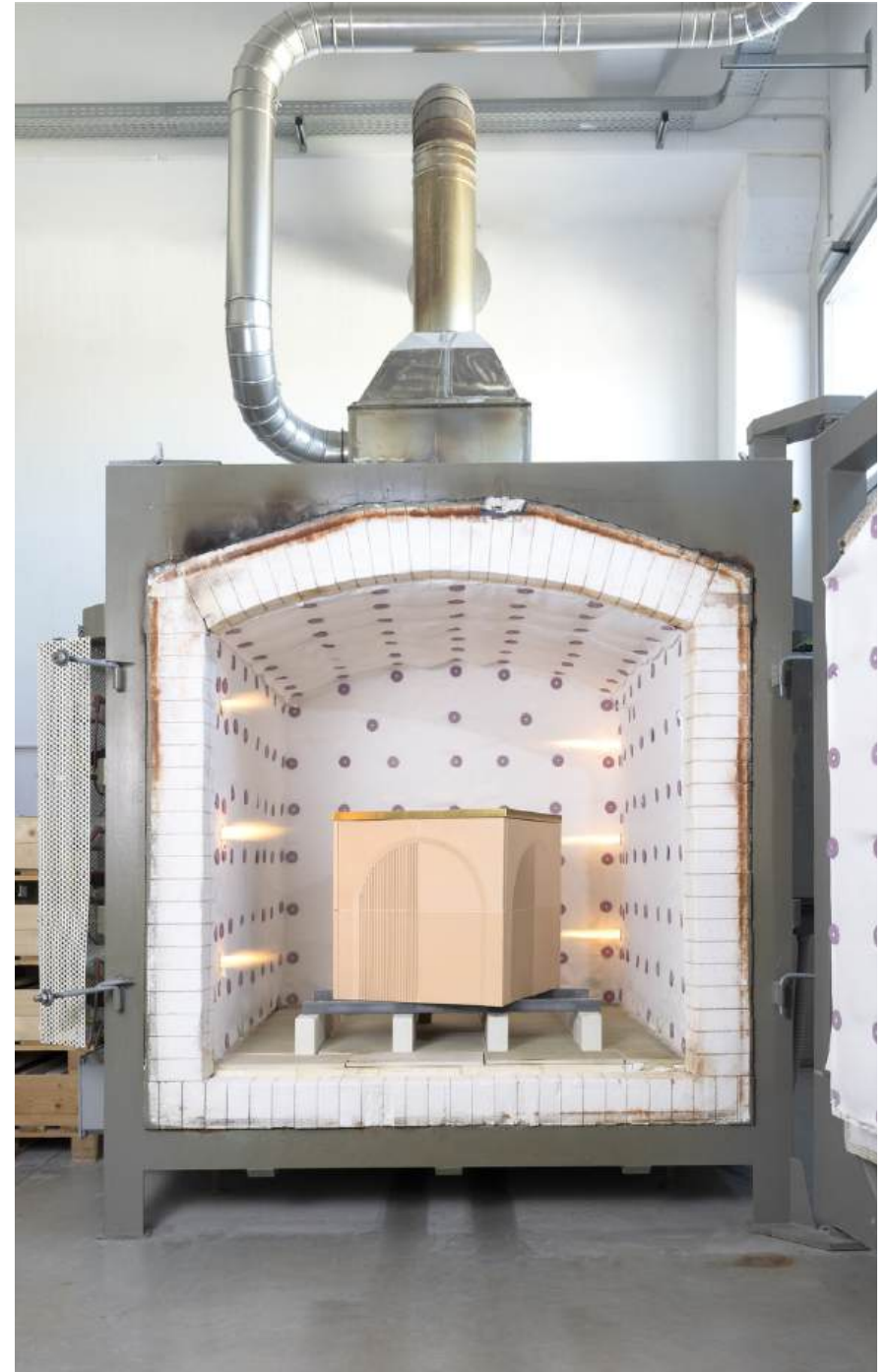

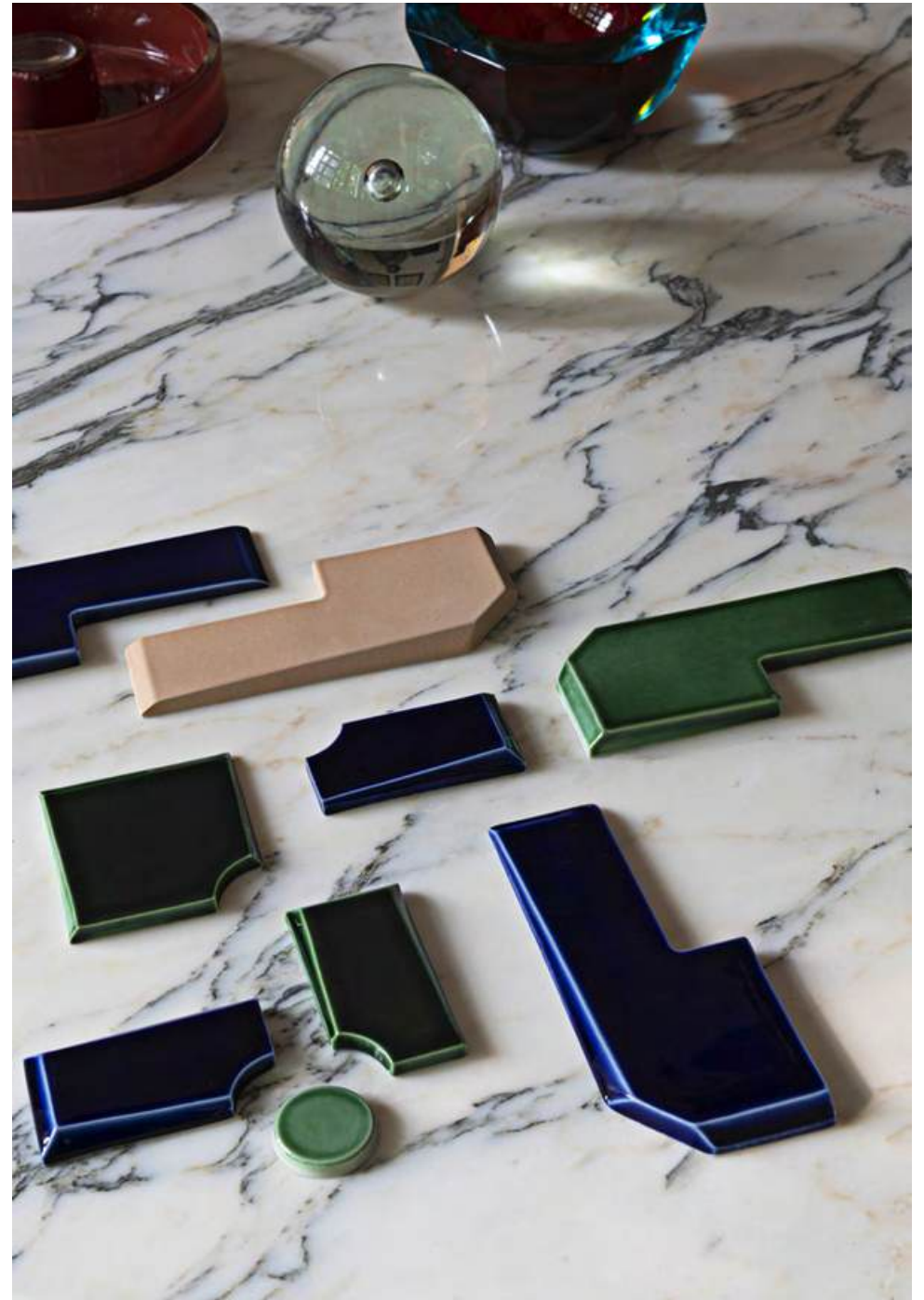
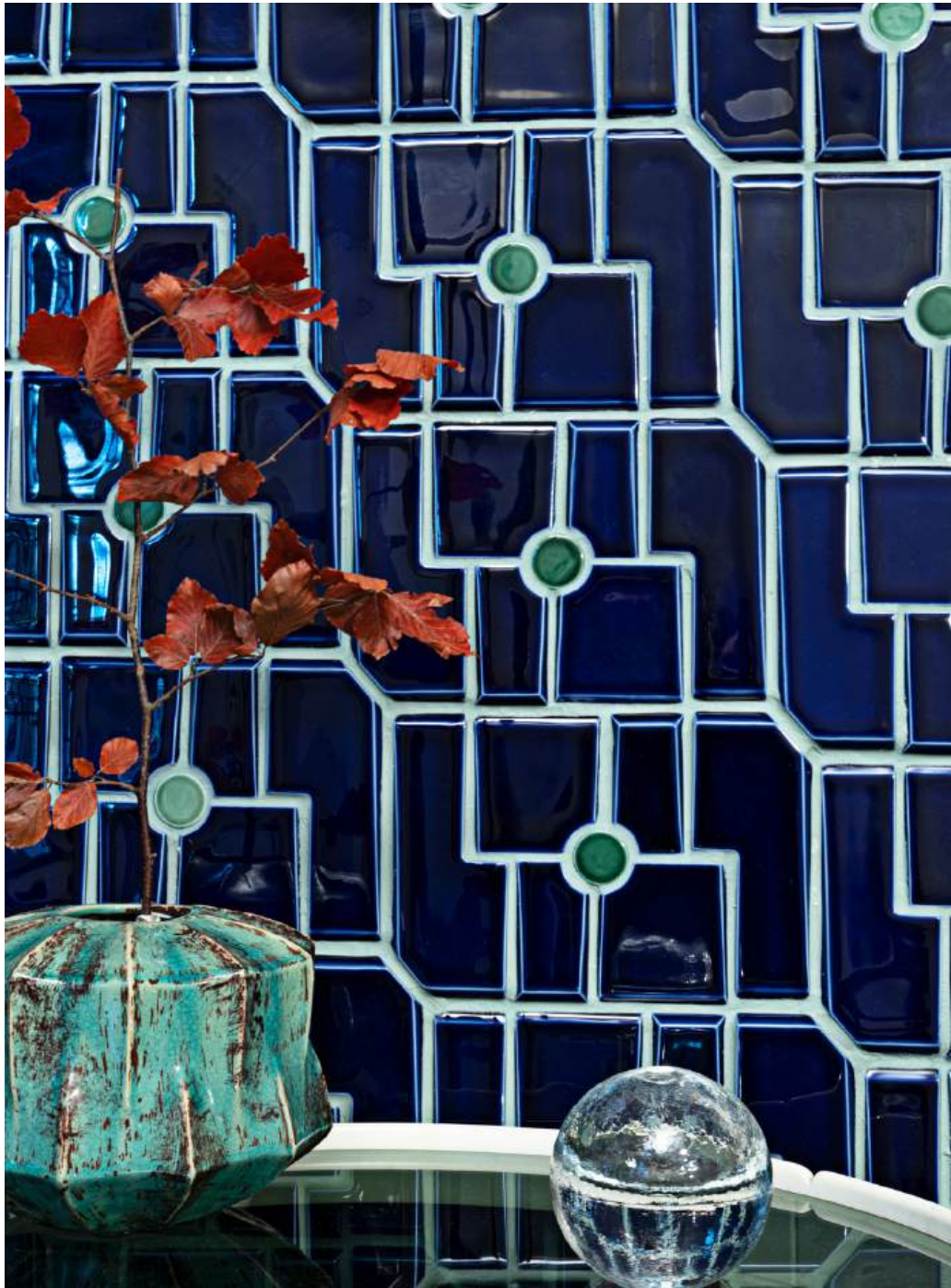

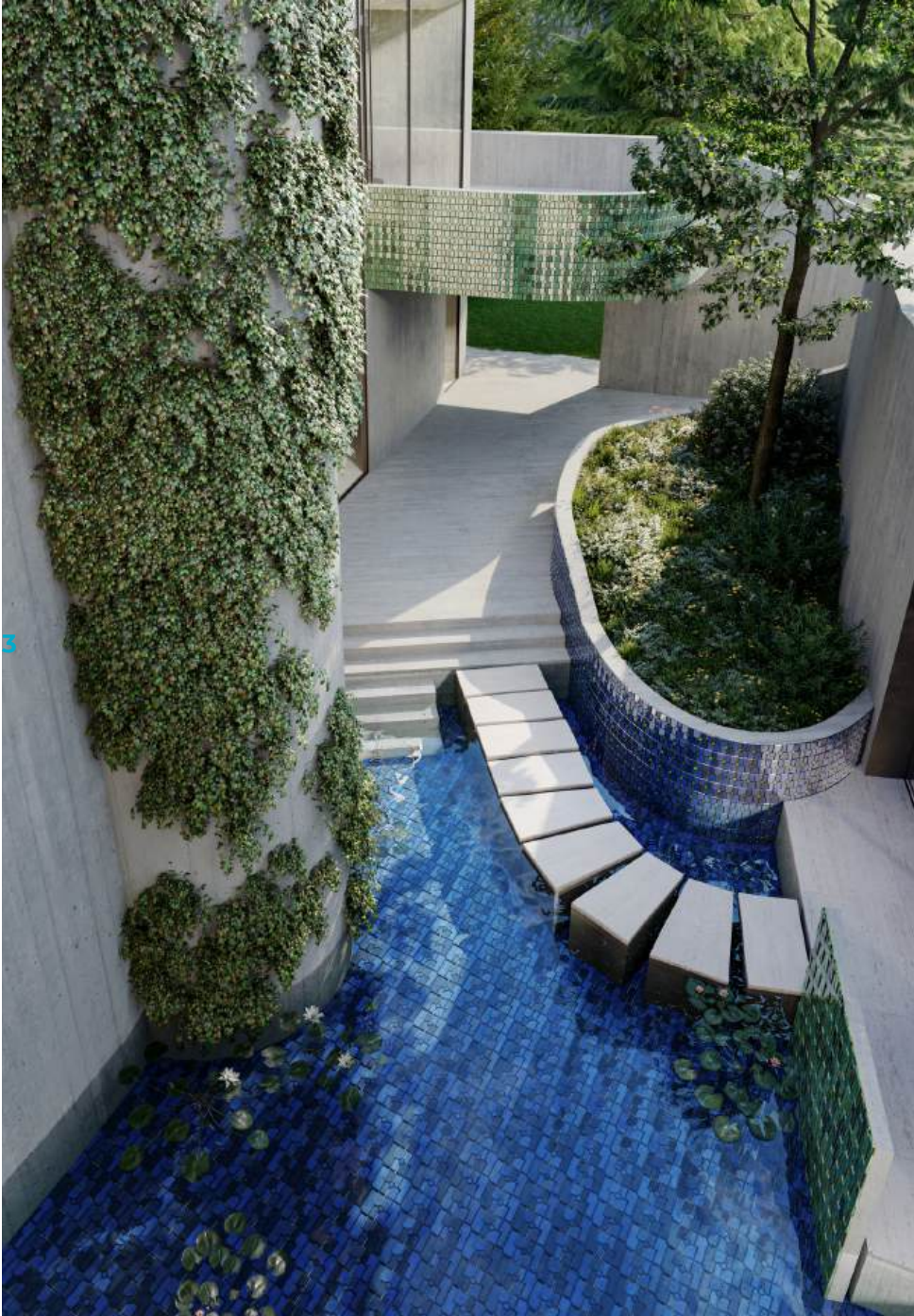



PRODUCTS DETAILS

- 1** - The Arena collection
Design by Giacomo Totti
- 2/3** - The Maya collection
Design by Giacomo Totti
- 4/5** - Cadenza
Design by Kejun Li
- 6** - The Maya collection
Design by Giacomo Totti
- 7** - The Calipso Collection
Design by Giacomo Totti
- 8** - The Cross Collection
Design by Giacomo Totti

Uk, Spain & Portugal Distribution



Ninefifty

Lavastone & Handmade Terracotta Tiles

A journey began in Caltagirone, a city renowned for the production of artistic **ceramics** and whose urban landscape is a testament to humanity's creative genius. This is where Nicolò and Fausto – flanked by the creative direction of Margherita Rui – created Ninefifty. The ninefifty range of floor and wall tiles is the result of **research, experimentation** and analyses into the methods and processes possible with these materials.

This is how ninefifty floor and wall tiles are made, working by hand, using new processes to reinterpret ancient methods in a way that is consistent with a modern vision of production. Ninefifty is a net zero company, they have decided to invest in a sustainable business strategy that extends from their products to their business structure: a short supply chain that lets us have a good degree of control over raw material quarrying.



Margherita Rui - Art director





1



2



3

PRODUCTS DETAILS

1 Righe - Grigio calcare

- **Materials:** glazed lava stone
- **Dimensions:** 15x15cm

2 Scie - Verde bosco

- **Materials:** glazed lava stone
- **Dimensions:** 20x20cm

3 Segni - Bianco burro, giallo zolfo, viola mosto, rosso mattone

- **Materials:** hand-made glazed terracotta
- **Dimensions:** 15x15cm

4 Alfabeto - Giallo Zolfo

- **Materials:** Lava stone with glaze base hand painted decor
- **Dimensions:** 15x15cm

USA, UK and UAE Distribution

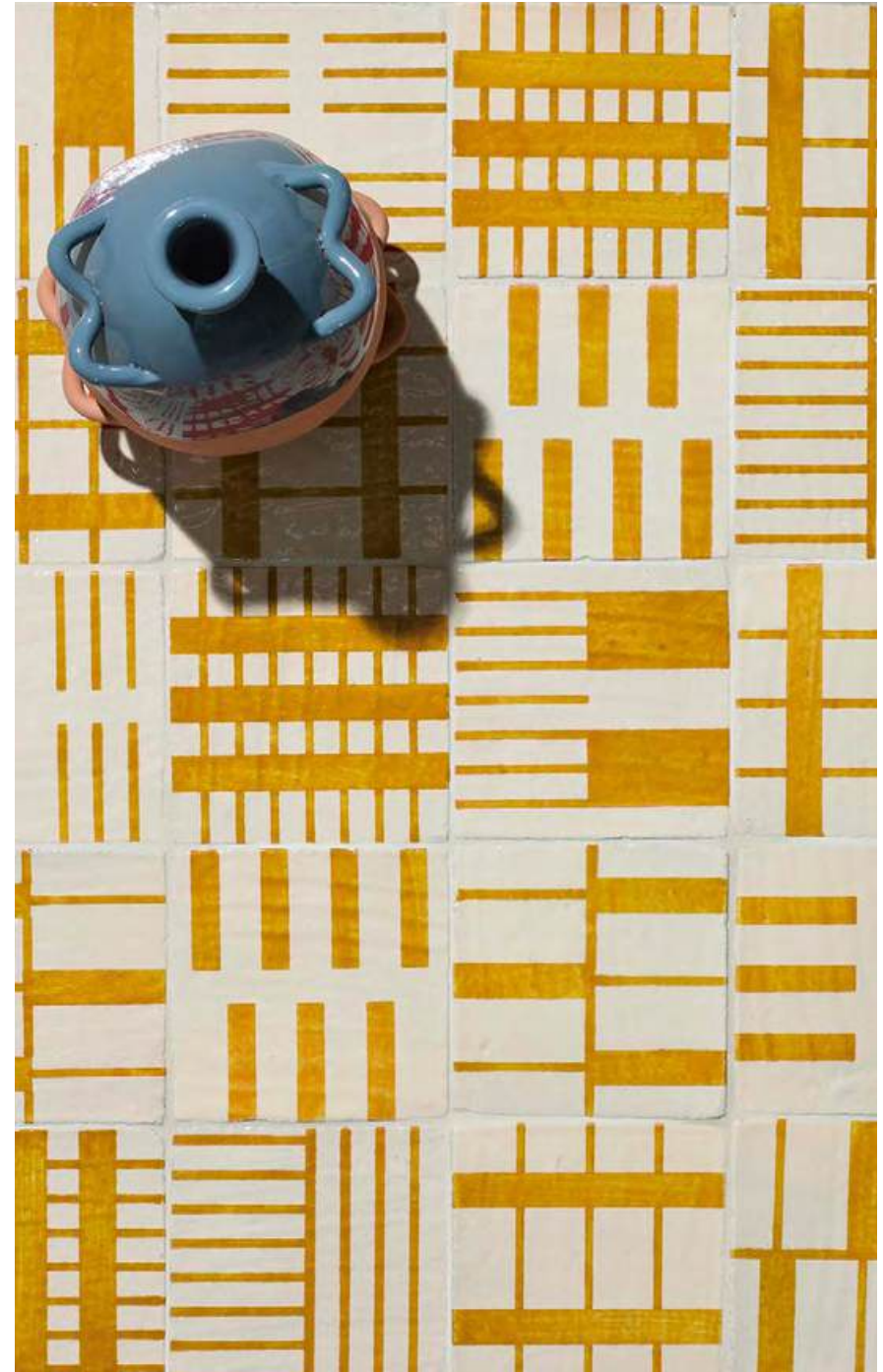

FURNITURE

Dante Negro

Outdoor Furniture

Dante Negro has been forging outdoor furnishings since 1964. In recent years, after having handed it down from father to son, the company has been transformed into a contemporary brand with an international scope focused on the **culture of design**, under the Creative Direction of **Margherita Rui**.

Three outdoor collections, a bespoke service and a network of artisans. **Glass, wood** and **marble** are just some of the materials that metal has been combined with to bring to life designs of varying degrees of complexity conceived by architects and designers.

Dante Negro is a **production district**, a group of businesses able to answer to any demand and rise to any design challenge



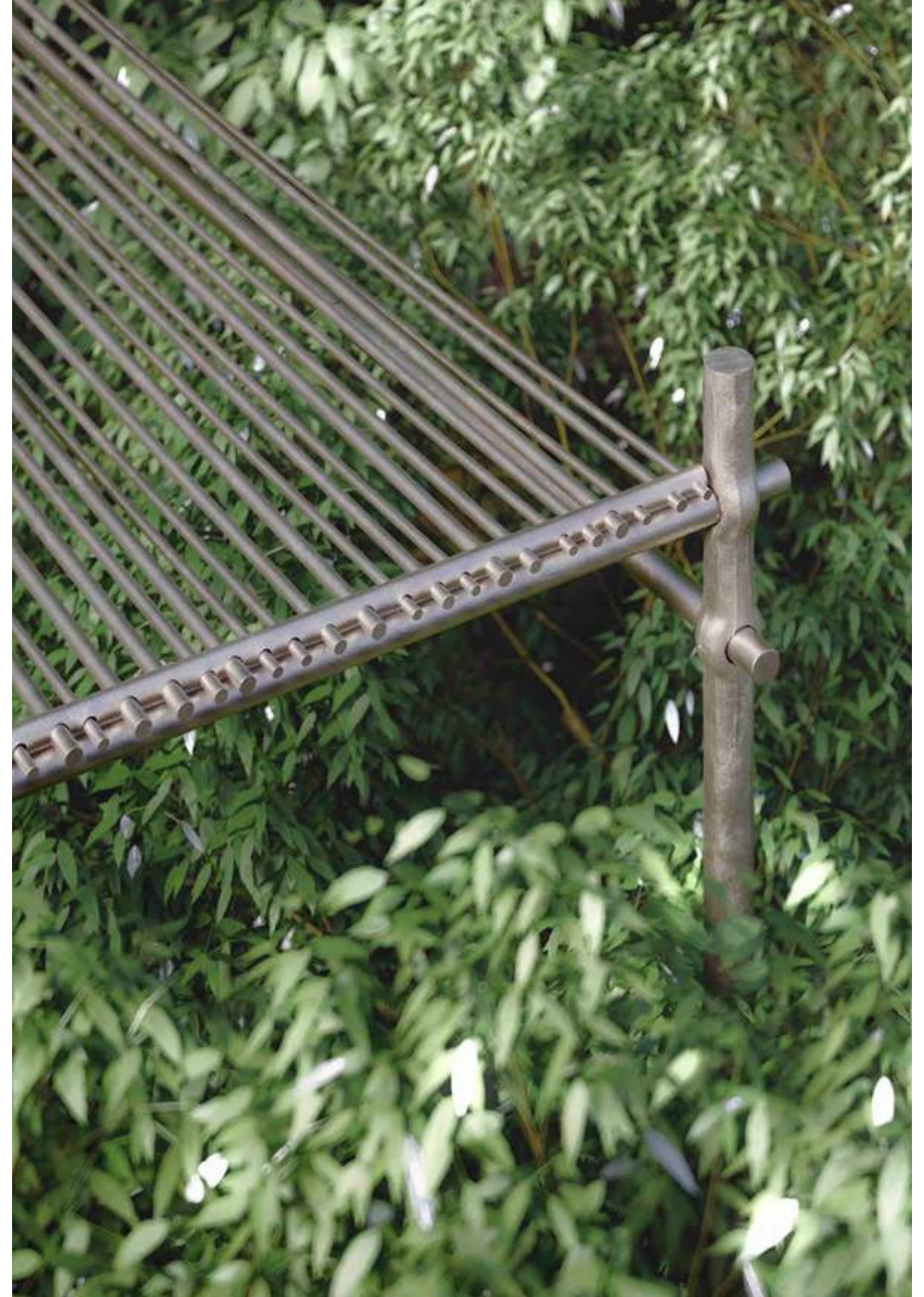





5



6



7

PRODUCTS DETAILS

1/2 - Bambusae Collection, Gazebo, Table and Chair
Design by Zanellato/Bortotto

3 - Corda collection, corda chair
Design by Zanellato/Bortotto

4 - Heritage Collection

5/6/8 - Dolmen Collection
Design by Margherita Rui

7 - Dolmen Collection
Design by Margherita Rui

Worldwilde Distribution



Cider

Office Furniture

Cider Group is a forward-thinking European design house shaping the future of workplace environments. Driven by what they call an “essentially fabricating intelligence,” the brand creates furniture that acts as a tool for cultural and organizational transformation.

Grounded in humility, boldness, and a deeply human client culture, Cider designs pieces that connect people to their workspace with clarity, sensitivity, and purpose. As they express, “furniture becomes the instrument of an alchemy for more creativity, innovation, and self-realization.”

Within the **ATLANTE Design** portfolio, Cider brings a distinctive authorial voice—refined, human-centered, and attuned to the evolving rhythms of contemporary work.







PRODUCTS DETAILS

- 1** - Cardigan pouf
Design by Desormeaux / Carrette
- 2** - Curl Armchair
Design by Fred Rieffel
- 3** - Queen Armchair
Design by Cider Edition
- 4** - Virgule Desk & Gregor Console - Design by Cider Edition;
Cloud.9 Sofa - Design by Julien Vidame;
Linus Chair - Design by Marco Dessi; Trio Coffee Table - Design by Nendo
- 5** - Delphine Pouf
Design by Delphine Bigand



La Manufacture Paris

Furniture

La Manufacture is a brand where **design** and **fashion** collide. A brand where a certain je ne sais quoi of French allure meets the best Italian craftsmanship.

A certain idea of French lifestyle (re)interpreted by world-renowned international designers. Each collection will highlight world-class **craftsmanship**, **timeless aesthetics** and **enduring quality**.

Halfway between design and art, their refined and modern collections reflects this shared philosophy to consistently seek out the best, unique and evocative designs.





1



2





4



5



6

PRODUCTS DETAILS

1 Wired Chair

Design by Michael Young

2 Soufflé Mirror

Design by Luca Nichetto

3 Ensemble

Design by Gardian Norguet

4 April chair

Design by Neri&Hu

5 Allié

Design by Luca Nichetto

6 Moos Modular sofa

Design by Sebastian Herkner

7 Moro Armchair

Design by Sebastian Herkner



Mediterranea design

3D Printed Furniture & Objects

Mediterranea is Medaarch's indoor & outdoor furniture collection born from the talent of Italian design, **new technologies** and the beauty of Made in Italy **craftsmanship**, to create objects that embody this vision and passion. Armchairs, stools, dining chairs and seating are made through the **3D printing** process with an environmentally friendly material and are generated thanks to a computational approach to design. But above all they embody the special link between **digitization** and **artisan feeling**.

Part of the Mediterranea project is Unique, the collection of 3D printed ceramic vases. Mediterranea is an innovative project that is transformed into furnishings and objects capable of telling a new, functional and emotional design, and of designing new and evocative spaces.









PRODUCTS DETAILS

- 1 Santorini Chair
Design by Mediterranea Edition
- 2 Enna Hight Table
Design by Mediterranea Edition
- 3 Fiordo Gres Vases
Design by Mediterranea Edition
- 4 Santorini Chairs
Design by Mediterranea Edition
- 5 Ischia Chair
Design by Mediterranea Edition
- 6 SuperEasy Handles and Planter
Design by Marco De Luca

Worldwide Distribution



INDEPENDENT DESIGNERS-MAKERS:

Unique Pieces, Accessories & Lifestyle

Ari De Luca

Ceramic Decorations

Arianna De Luca is an Italian **ceramist** and **designer**.

Paying homage to Mediterranean elements and celebrating the Italian heritage, Arianna's objects stand out in the domestic environment by transforming **archetypes** of tradition into **pop, bold figures**.

Perfect for Boutique Hotels and Hospitality Project, Lifestyle and Gift Shops









4



5



6

PRODUCTS DETAILS

1 - La Graziosa Collection

2/3 - Riviera collection

4 - Prezioso candelholder from Bonanza collection

5 - Ramina from Folclorista collection

6 - Olio from Folclorista collection

7 - Riva lamp from Folclorista collection

Worldwilde Distribution



ccontinua + mamt

Tableware & Unique Pieces

Ccontinua+mamt is the result of the four handed collaboration between Chiara Caselli and Francesco Carrasso an Amsterdam based italian creative duo with a complementary and multidisciplinary approach, they develop projects in different fields: from **painting** to **ceramics** and **textiles**, to interior design and landscape architecture.

Their investigation focuses on **domestic rituals** and interaction between people, objects and environment. Craft melts with a primitive and folkloristic imaginary, playing with **human** and **social** narratives of a contemporary collectivity with an eye on the **tradition**.



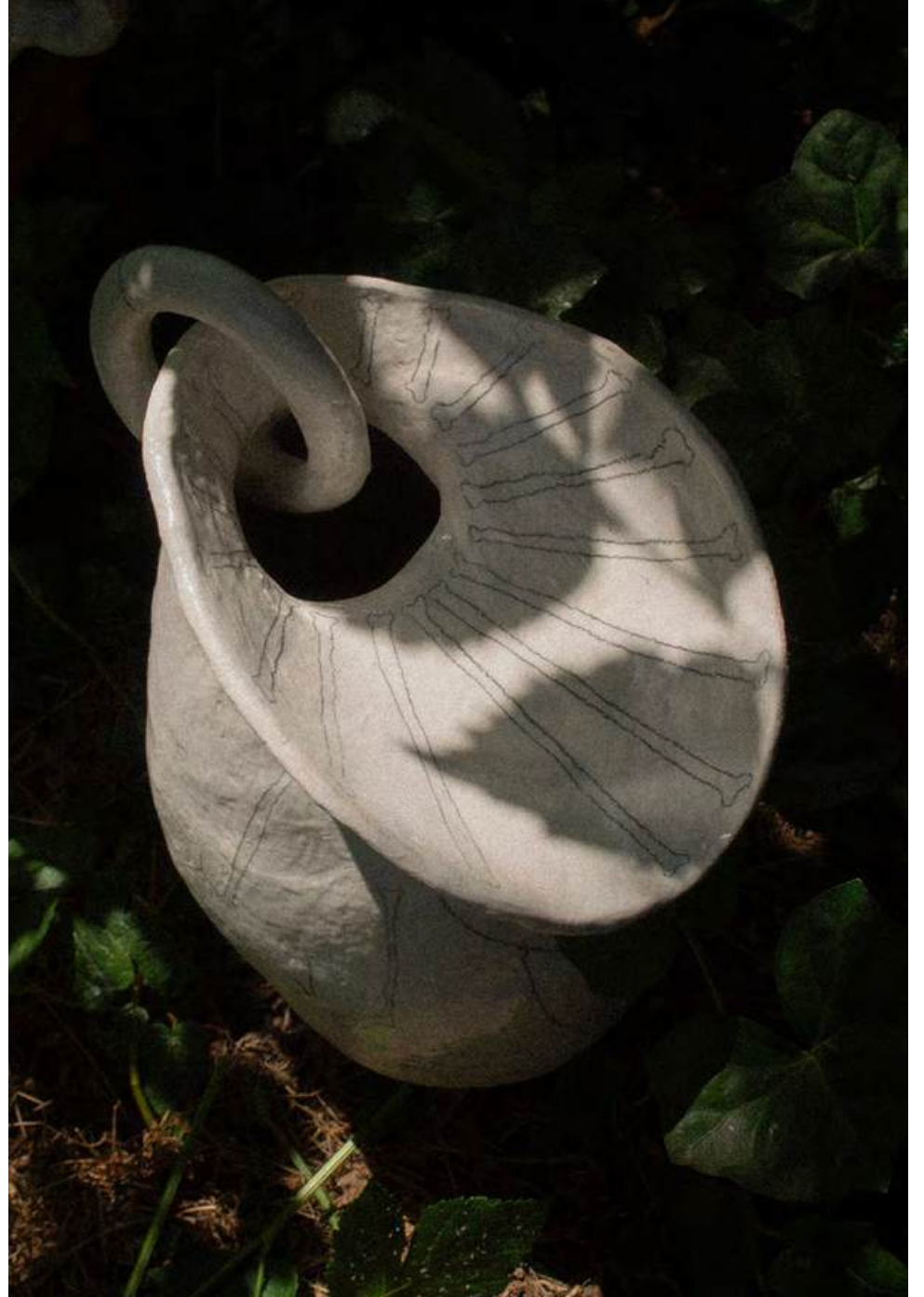



PRODUCTS DETAILS

1 Vases from the Ossa collection, sculptural clay objects, handcrafted.

2 Liquid soul under the moon Arazzo

- Materials: 100% light mocha cotton - foam (inside) - white cotton thread - spray paint
- Dimensions: 130 x 175 cm (average thickness - 3 cm)
- Techniques: Embroidery realised by hand-machine, using
- XIX century Cornely machine - Free hand spray on textile

3 White Lava Collection

- Materials: materials mix of four clay bodies + volcanic sands + pink sand - Porcelain slip - White glazing liner - Transparent glaze
- Techniques: entirely handmade - wheel-throwing - free-hand drawing

4 Tattooed Ceramics Collection, Primoquarto

- Materials: clay - underglaze pencils - inner transparent glaze
- Dimensions: Ø 30 x H 35-40 cm
- Techniques: entirely handmade - wheel-throwing - free - hand drawing



Worldwide Distribution

Giovanni Botticelli

Mirrors and Lightings

With a strong focus on creating mirrors that could express his needs for beauty, arts and functionality, Giovanni Botticelli is a Rome-based designer whose practice encompasses product, furniture, eyewear design and experimental works, often transcending the distinctions between different fields of creativity.

Botticelli's practice contemplates both industrial production and artisan techniques focusing on ceramics, **glass** and **metal** expanding his expertise through formative experiences at ENSA in Limoges and Abate Zanetti in Murano. His way of working with materials normally used by specific industries and reinvented and adapted to everyday objects like the use of the cellulose acetate makes his works new and sophisticated.





1



2

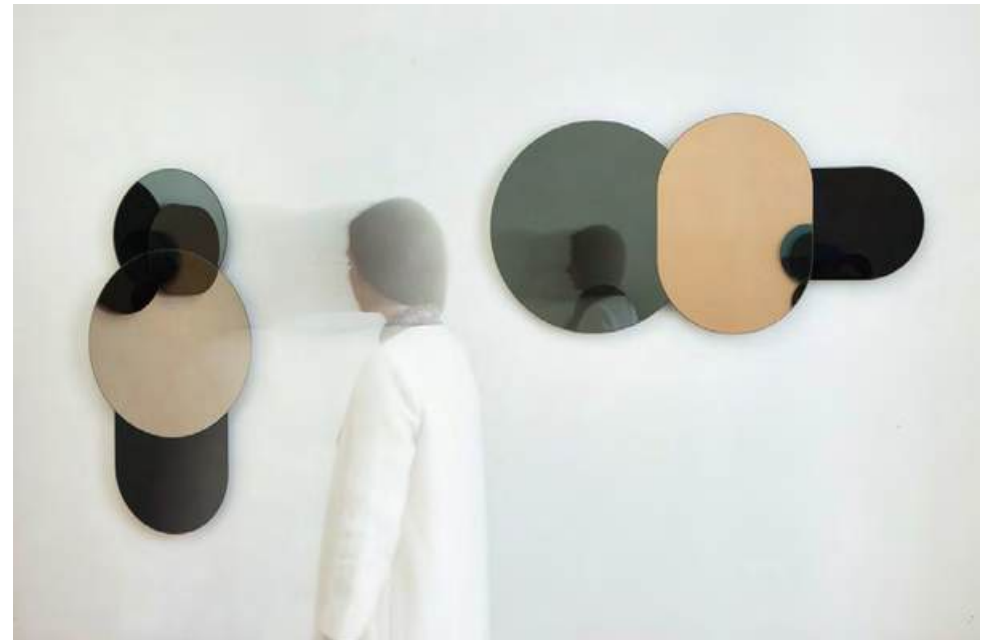



PRODUCTS DETAILS

1 Minima small from Vetrografica Collection

- Materials: lacquered glass, lacquered mirror

2/7 Mirror Lamps from Vetrinette Collection

- Dimensions: 34 x 34 x 12cm
- Materials: Extra-clear mirror, Extra-clear lacquered mirror, Lacquered glass, Coloured satin and sandblasted glass, Colored sand

3 Model Him from Personale Collection

- Dimensions: 62 x 70 x 5 cm
- Material: Colored sandblasted glass, Colored mirror, Back steel bracket

4 Wall mirrors from Equilibrista Collection

- Materials: lacquered glass, colored mirror

5/6 RING, Aura and Nova NINFEE from



Giorgio Bena

Furniture & collectables

Born and raised near Turin, where he currently lives and works. He is involved in bespoke furniture and interior design, curating in art and design, and education. In his work he tries to enhance the **human factor**: projects and objects made by **people** and for **people**, born from dialogue and collaboration, from the transmission of skills and knowledge. Since 2022 he has started his self- production activity linked, by vocation but not exclusively, to **metal** as a **technical material** but with **experimental potential**.



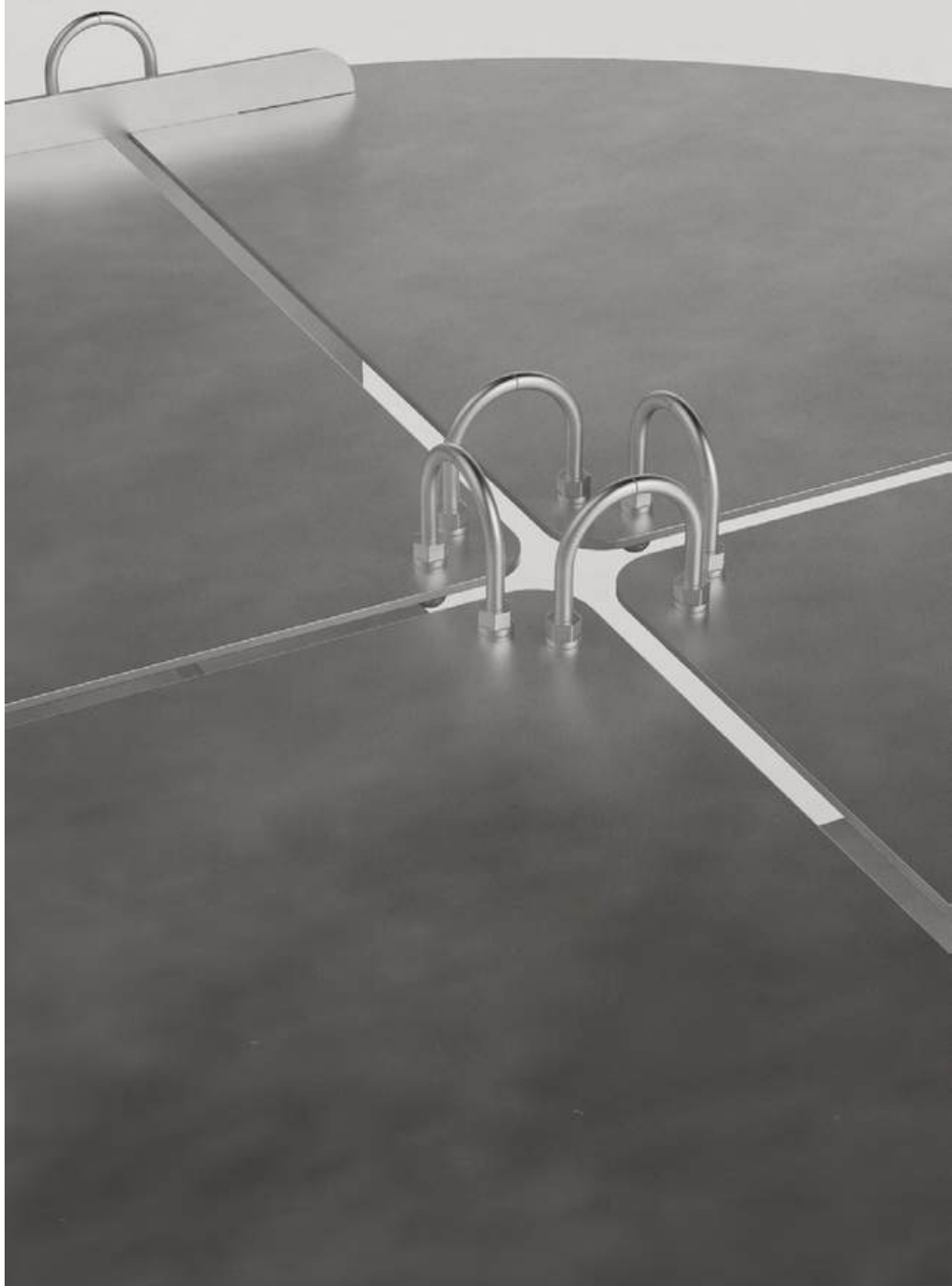

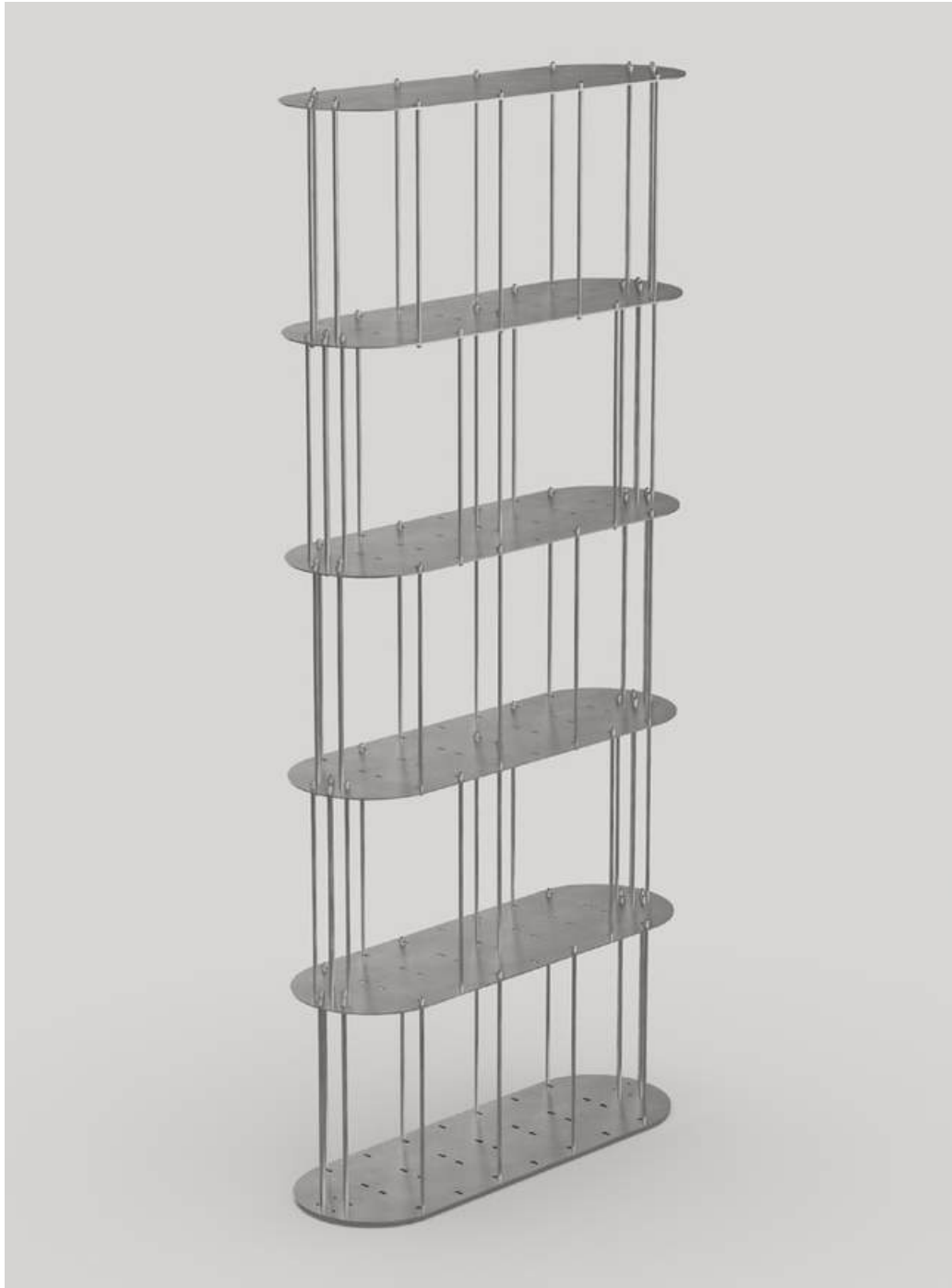



5

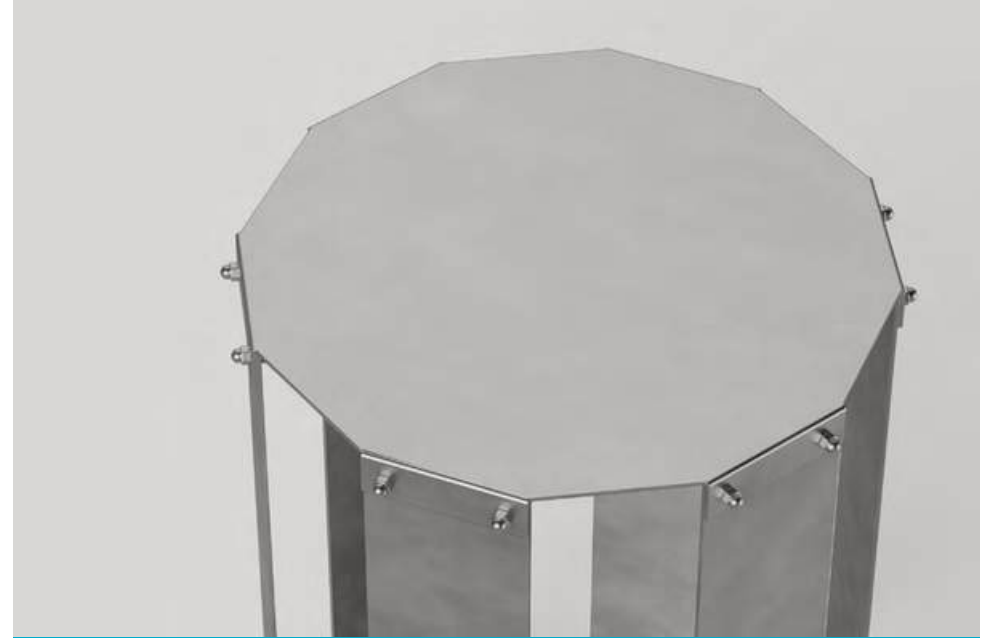

6



7

PRODUCTS DETAILS

1-2 Lockwerk Coffee Table acciaio INOX / stainless steel

- dimension: 80x80x45 cm

3-4 Lockwerk Bookshelf acciaio INOX / stainless steel

- dimension: 90x30x205 cm

5 Burger DDC Couple acciaio INOX / stainless steel

- dimension: 1: 60x60x40 cm | dimension 2: 40x40x60 cm

6 Burger DDC Side Table acciaio INOX / stainless steel

- dimension: 40x40x69 cm

7 22Burger HEX Side Table acciaio INOX / stainless steel

- dimension: 40x40x60 cm

8 Lockwerk Side Table acciaio INOX / stainless steel

- dimension: 30x30x44 cm



Stamuli

Furniture & Home Accessories

Stamuli is a design studio made of a collective of creative and technical people. Stamuli love rationalism, and they always try to conceptualize decorations in their projects. **Colour** often plays an important role in their design. Stamuli have a **construction-oriented mindset**, and they like to project-manage what they design. Their expertise focuses on **materiality** with an eye on **sustainability** and how to use materials of the future. They have a great knowledge of **recycled materials** and care to develop project with low impact on the environment in terms of production and logistics.







3



4



5

PRODUCTS DETAILS

1 Tagada Collection - Mirror MI01

- Materials: Plywood, Mdf, Laminate
- Dimensions: 52 cm x H116 cm x 25 cm depth base

2/3 Tagada Collection - Chairs

- Materials: Plywood, Laminate
- Dimensions: 48cm diam x H80cm x 44cm diam base

4 Tagada Collection - Oval Table

- Materials: Plywood, Mdf, Laminate, Stainless steel
- Dimensions: Top 140x90 cm x H75 cm x 50x30 cm diam base

5 Tagada Collection - Mini Chair

- Materials: Plywood, Laminate
- Dimensions: 46 x 28 x 25 cm

6 Tagada Collection - Coffee table

- Materials: Plywood, Mdf, Laminate
- Dimensions: top 85cm diam x H30cm x 50cm diam base

7 Tagada Collection - Wool Carpet

- Materials: wool 100%
- Dimensions: 220x280cm or 280x360cm

8 Unstressed Chair

- Materials: Aluminium
- Dimensions: 49cm x H68cm x 49cm depth base



SPECIAL COLLAB

BCXSY x Sidreh

Rugs

BCXSY is an Amsterdam-based design collective, founded in 2007 by Boaz Cohen (IL/NL) and Sayaka Yamamoto (JP).

Sidreh is a non-profit organization focused on improving the socioeconomic situation of Bedouin women living in the Negev Desert.

Balance rugs collection is designed by BCXSY

and produced by Sidreh. Balance embodies the possibility of finding a modern context for an ancient craft.

Balance embodies the possibility of finding a modern context for an ancient craft.









PRODUCTS DETAILS

1 Balance Rugs

- **Type A:** 110x240cm
- **Type B:** 110x300cm
- **Type C:** 220x240cm
- **Type D:** 110x180cm
- **Type E:** 80x190cm
- **Type F:** 140x170cm
- **Type G:** 110x270c



2 Detail of a Rug in Dune colorway

3 Rug Type F: 140x170cm in Dune colorway

4 VRug Type C: 220x240cm in Dune colorway



Worldwide Distribution
with the exception of Denmark, Norway, Sweden, Switzerland and Germany

Please get in touch for pricelist and catalogues

info@atlante.design

Thank you